

CERTIFIED LAND CORNER RECORDATION

DESCRIPTION OF CORNER EVIDENCE FOUND, AND ORIGINAL RECORD (if known)

LOCATION
S.26 S.25
S.35 S.36
T.16N., R.64W.
6th P.M.

Found a "WCCR" stone; from which the section corner bears S 44°58' W, 56.58' distant. "WCCR" stone set by Laramie County Surveyor.
G.L.O. record: Granite boulder, 16 x 8 x 6, Alfred M. Rogers, 1871.

DESCRIPTION OF MONUMENT AND ACCESSORIES ESTABLISHED TO PERPETUATE THE ORIGINAL LOCATION OF THIS CORNER:

At the corner: No monument set.

Accessories: R.P.#1 - A 1 1/2" x 30" iron pipe w/ brass cap bears S 44°27' E, 56.75' distant. Set witness post, 1.5' east of R.P.#1.
R.P.#2 - A 5/8" x 24" rebar w/ SurvKAP bears S 45°33'40" W, 56.37' distant.
R.P.#3 - A 5/8" x 24" rebar w/ SurvKAP bears N 44°32'50" W, 56.87' distant.

SKETCH, WITH COURSE AND DISTANCE TO ADJACENT CORNER IF DETERMINED IN THIS SURVEY.
(May Sketch or Paste Reproduction on Reverse Side.)

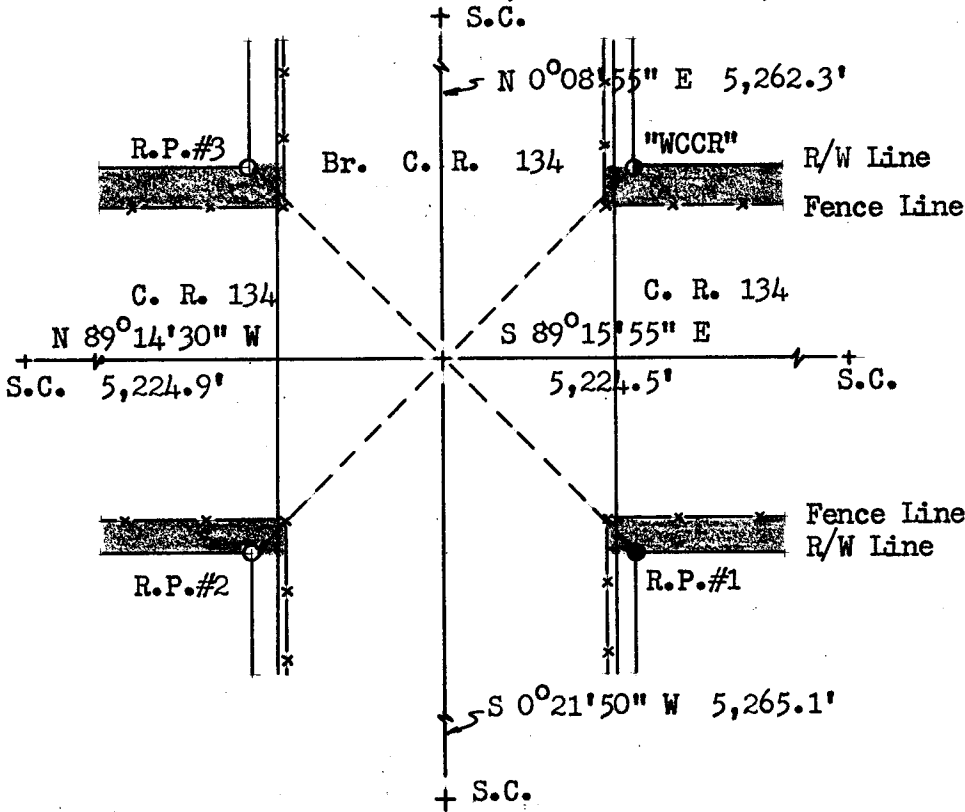

Brass cap set 6" above surface.
Brass cap stamped:
C. R. R/W
LS 519 1972

Shaded areas denote encroachments.

I, R.L. Hudson certify that I have carefully performed or reviewed the work done on the diagrammed corner as reported on this recordation form and approve the same.

R.L. Hudson
Signature of Surveyor

Wyoming L.S. No. 519
Registration No.

STATE OF WYOMING,
Office of Clerk and Recorder,
County of Laramie

This "corner record" was filed for record on the 9th day of August, 1972, was noted on the cross-index plat and is assigned page No. 16-64, in book No. ONE

Jolly B. Hillman
County Official

Cross Index No.	_____	T.	_____	R.	_____	Mer.
	_____	T.	_____	R.	_____	Mer.
	_____	T.	_____	R.	_____	Mer.
	_____	T.	_____	R.	_____	Mer.
	_____	T.	_____	R.	_____	Mer.
	_____	T.	_____	R.	_____	Mer.
	_____	T.	_____	R.	_____	Mer.

The State of Wyoming }
County of Laramie } SS

This instrument was filed for record
at 9:10 o'clock P. M. on the
9th day of August
A. D. 19 1921 and duly recorded in
Book on page

John B. Williamson

County Clerk & Ex-Officio Register of Deeds
By Deputy